



XIII
INTERNATIONAL
WINTER ROAD
CONGRESS

QUÉBEC, FEBRUARY 8 TO 11, 2010



SUSTAINABLE WINTER SERVICE FOR ROAD USERS

Block dispatching for HGVs on problematic road sections during extreme winter weather conditions

Susanne Schulz

Karlsruhe Institute of Technology
Institute of Highway and Railroad Engineering

Research Associate

susanne.schulz@kit.edu



BACKGROUND

Research Project «Coping with High Traffic Volumes on Federal Motorways in Winter»

(by order of the Federal Ministry of Transport, Building and Urban Affairs (BMVBS) and represented by the Federal Highway Research Institute (BASt))

BACKGROUND

- HGVs blocking the road in winter cause
 - Long traffic jams
 - High economic costs
 - Winter maintenance vehicles locked in traffic jams



BASIC CONDITIONS

- Region with heavy snowfall
- High inclination (> 4%)
- Detailed Road Weather Information (RWIS)

- Stop on the right-hand lane
- Easy understandable traffic signs
- Stopping time of approx. 10 minutes
- Detailed information for the road users

BASIC CONDITIONS

- Region with heavy snowfall
- High inclination (> 4%)
- Detailed Road Weather Information (RWIS)
- Stop on the right-hand lane
- Easy understandable traffic signs
- Stopping time of approx. 10 minutes
- Detailed information for the road users
- Baden-Wuerttemberg, Motorway A8
- Bavaria, Motorway A8 East



ORGANISATION

- Involved institutions:
 - Highway surveillance centres
 - Highway Police
 - Different public authorities
 - KIT (Institute of Highway and Railroad Engineering)
- Concept of traffic signing
- Public relations
- Design of operation schedule

CONCEPT OF TRAFFIC SIGNING

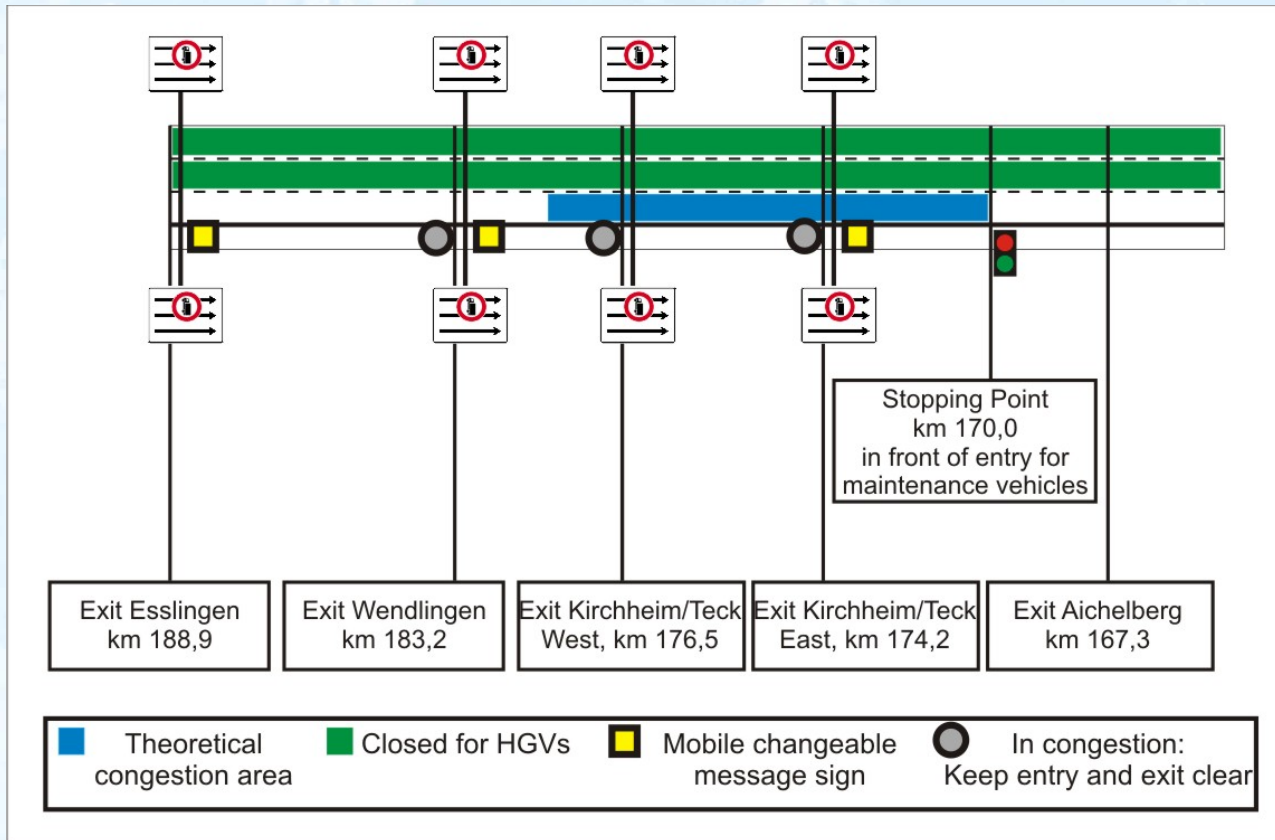

Trivision traffic signs

BLOCK DISPATCHING FOR HGVS ON PROBLEMATIC ROAD SECTIONS DURING EXTREME WINTER WEATHER CONDITIONS

CONCEPT OF TRAFFIC SIGNING

■ Mobile changeable message signs



PUBLIC RELATIONS

Посылать блока

Грузовые автомобили задерживаются перед подъемниками до тех пор, пока автомобильные самоочистители не уберут проезжую часть. Это позволяет избежать на автобанах:

- застревания грузовых автомобилей перед подъемниками
- лишних заговоров и аварий

Поэтому грузовые автомобили:

- не имеют права обогнать
- должны выстроиться в ряд на правой полосе движения и сократить дистанцию
- должны оставить свободными съезды и выходы на прилегающие дороги
- должны переждать уборку снега

Spedizione del blocco

In presenza di neve o ghiaccio su strade in salita, i camion verranno bloccati fin tanto che i veicoli d'emergenza non avranno pulito il fondo stradale. Tale manovra impedisce in autostrade:

- che i camion vengano fermati in salita
- incidenti

Pertanto si applicano ai camion le seguenti regole:

- evitare sorpassi
- allinearsi e mantenersi nella corsia di destra
- se utili di una colonna, attivare i lampeggianti d'emergenza
- lasciare libere ferrate e uscite di svincoli
- attendere la rimozione della neve

Blockabfertigung für LKW

Bei Stau: Ein- u. Ausfahrt frei halten

Blockabfertigung für LKW

IMPRESSUM
 Konzeption und Text: Autobahnpolizei Stuttgart
 Gestaltung: Kreisverkehrs- und Erhaltungszentrale Verkehrspolizei BW

BLOCK-abfertigung für LKW im Winter

Spedizione del blocco

Blok odprawa
 Envio del bloque

Посылать блока
 Block dispatching

Spedizione del blocco

Innenministerium Baden-Württemberg

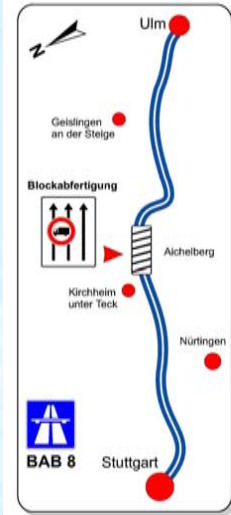

Blockabfertigung

LKW werden bei winterlichen Verhältnissen auf Steigungen so lange angehalten, bis die Selbstreinigungskraft der Fahrbahn geräumt haben. Dies vermeidet auf Autobahnen:

- das Liegenbleiben von Lkw an Steigungen
- unnötige Staus
- Unfälle

Deshalb gilt für Lkw:

- nicht überholen
- auf rechten Fahrbahnen aufsteigen und aufschließen
- am Kolonnenende Warmlicht einschalten
- Ein- und Ausfahrten von Anschlussstellen freihalten
- Schneeräumung abwarten

Block dispatching

In winter conditions trucks are to stop before hills until snow clearance vehicles have cleared the road surface. This prevents, in winter:

- Trucks coming to a halt on hills
- Unnecessary traffic jams and accidents

on the motorway. Therefore, trucks must:

- Not overtake
- Form a convoy on the right-hand lane and close up to each other
- Switch on warning lights at the end of the column
- Keep the entrances and exits of junctions clear
- Wait for snow clearance

Block dispatching

In winter conditions trucks are to stop before hills until snow clearance vehicles have cleared the road surface. This prevents, in winter:

- Trucks coming to a halt on hills
- Unnecessary traffic jams and accidents

on the motorway. Therefore, trucks must:

- Not overtake
- Form a convoy on the right-hand lane and close up to each other
- Switch on warning lights at the end of the column
- Keep the entrances and exits of junctions clear
- Wait for snow clearance

- Flyer
- Radio announcements
- Papers in trade journals
- Information at a regular's table for truckers



BLOCK DISPATCHING FOR HGVS ON PROBLEMATIC ROAD SECTIONS DURING EXTREME WINTER WEATHER CONDITIONS

OPERATION SCHEDULE

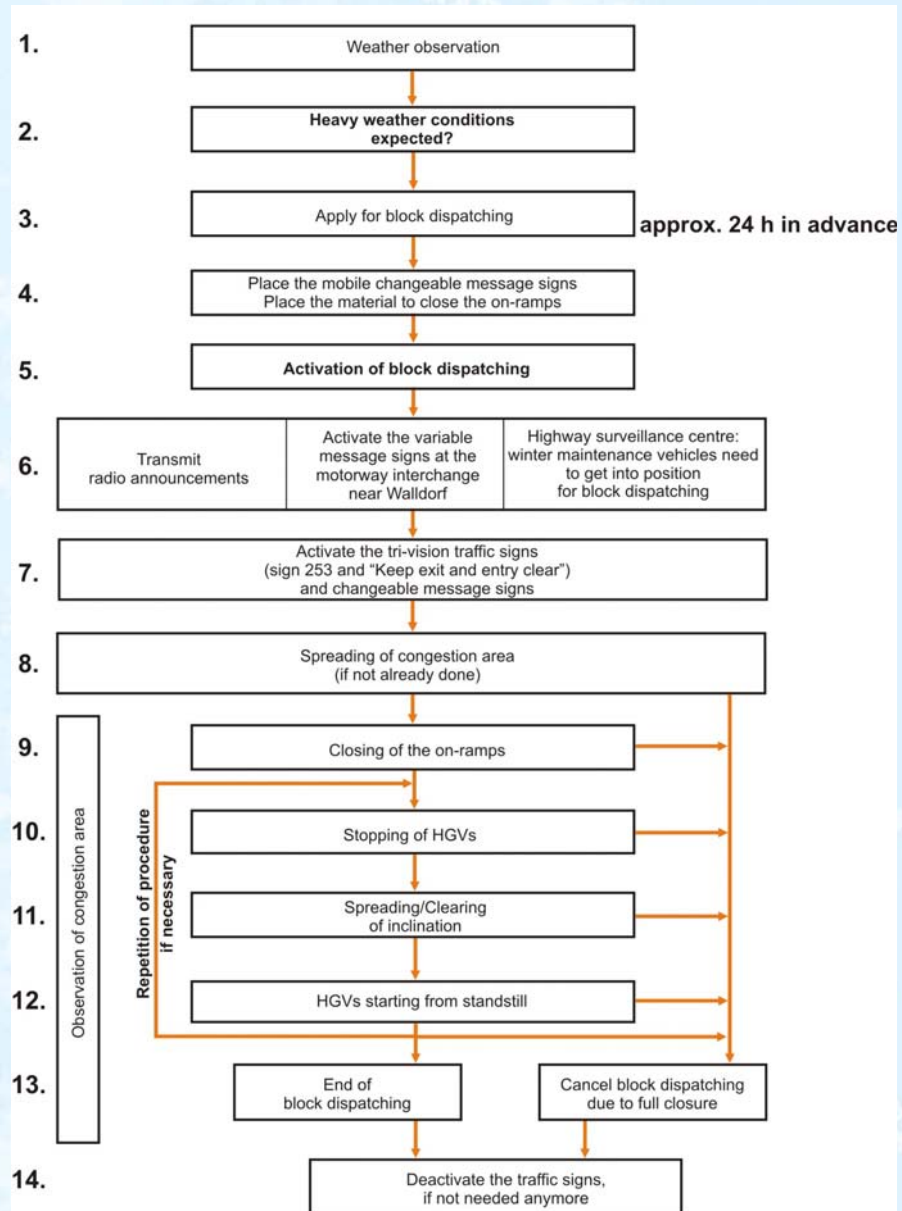

BLOCK DISPATCHING FOR HGVs ON PROBLEMATIC ROAD SECTIONS DURING EXTREME WINTER WEATHER CONDITIONS

RESULTS AND CONCLUSION

- So far no results about the stopping procedure itself, but:
 - Involved institutions think the measure is positive
 - Traffic signs are successfully in use
 - Acceptance of drivers is given



THANK YOU!